

BB02-YJ

CUSTOMER PRODUCT SPECIFICATION SHEET



BB02-YJ:- 1.00MM (0.039") PIN HEADER, SINGLE ROW, STRAIGHT, THROUGH HOLE TYPE, 02 TO 35 CONTACTS

SPECIFICATIONS

CURRENT RATING: 1AMP
 INSULATOR RESISTANCE: 1000 MEGOHMS MIN.
 DIELECTRIC WITHSTANDING: AC 300 V
 CONTACT RESISTANCE: 20m OHMS MAX.
 OPERATING TEMPERATURE: -40°C TO +105°C
 CONTACT MATERIAL: BRASS
 INSULATOR MATERIAL: THERMOPLASTIC, UL 94V-0
 STANDARD: LCP + 30% G/F
 PLATING: GOLD FLASH OR TIN OVER 30-50U" NICKEL
 SOLDERABILITY IR REFLOW: 280°C FOR 10 SEC
 WAVE: 250°C FOR 5-10 SEC
 MANUAL SOLDER: 380°C FOR 3-5 SEC

PACKAGING: LOOSE IN BOX OR BAG.

NOTES:

1. MINIMUM OVERALL PIN LENGTH (A+B+1.0): 5MM.

MATES WITH: - BB02-WD
 BB02-WE
 BB02-WF

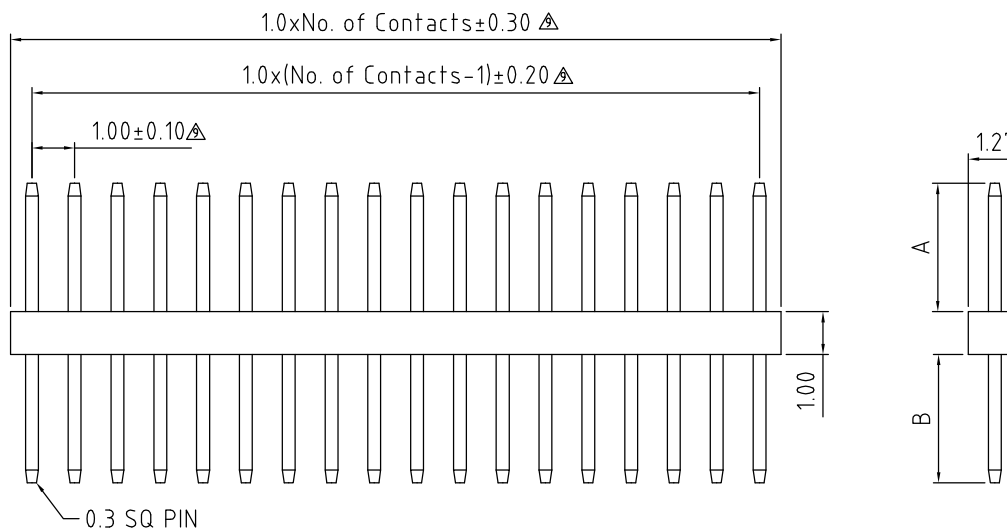
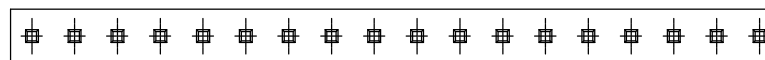

HOW TO ORDER

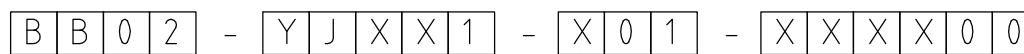

NO. OF CONTACTS:
02 to 35

CONTACT PLATING OPTIONS:
K = GOLD FLASH (STANDARD)
T = BRIGHT TIN
M = MATT TIN

PIN LENGTH A (1/10mm)
PLEASE SPECIFY PIN LENGTH REQUIRED
I.E. 2.5mm = 25
TOL. ±0.25mm
STANDARD = 15
MIN. = 10, MAX. = 80
(Please refer to Note 1 for more information.)

PIN LENGTH B (1/10mm)
PLEASE SPECIFY PIN LENGTH REQUIRED
I.E. 2.5mm = 25
TOL. ±0.25mm
STANDARD = 30
MIN. = 10, MAX. = 80
(Please refer to Note 1 for more information.)

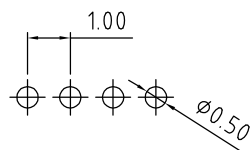

RECOMMENDED PCB HOLE LAYOUT

REV.	DATE & DRN
1.0	19/04/08-NYW- RELEASE
1.1	17/08/08-NYW- CHANGE PIN# FROM 05 TO 02.
1.2	11/08/08-NYW- ADD T AND M PLATING OPTIONS.
1.3	25/12/08-NYW- DRAWING MODIFICATION.
1.4	26/03/09 - NYW- REMOVE NOTE 1.
1.5	19/06/09 - NYW- CHANGE STANDARD A = 15.
1.6	18/08/11 - NYW- ADD MIN. AND MAX. A & B PIN LENGTH.
1.7	22/02/13 - NYW- ADD NOTE 1.
1.8	23/09/13 - NYW- AMEND MAX. PIN# TO 35.
1.9	19/03/14 - NYW- AMEND TOLERANCE.

Scale: 8:1	THIRD ANGLE	Unstated Tolerances: X ± 0.30 X ± 0.25 XX ± 0.15 XXX ± 0.10	Material SEE NOTE
Drawn: NYW			
App'd: XXX	Title: PIN HEADER		NOT TO SCALE
Date: 19 MAR '14	Revision: 1.9		Unit: mm

THIS DRAWING IS CONFIDENTIAL AND MUST NOT BE COPIED OR DISCLOSED WITHOUT WRITTEN CONSENT

Type BB02-YJ
BB02-YJ
Drawing Number:
Sheet 1 of 1
Drawing © E and O E