

BB02-AY:- 0.8x1.2MM PIN HEADER, DUAL ROW, STRAIGHT, SMT TYPE, 06 TO 100 CONTACTS

SPECIFICATIONS:

CURRENT RATING: 0.5AMP  
 INSULATOR RESISTANCE: 1000 MEGOHMS MIN.  
 DIELECTRIC WITHSTANDING: AC 300 V  
 CONTACT RESISTANCE: 20m OHMS MAX.  
 OPERATING TEMPERATURE: -40°C TO +105°C  
 CONTACT MATERIAL: PHOSPHOR BRONZE  
 INSULATOR MATERIAL: POLYESTER UL 94V-0  
 STANDARD: LCP OR EQUIVALENT  
 PLATING: GOLD, TIN OR SELECTIVE FLASH OVER 30-50U" NICKEL  
 SOLDERABILITY IR REFLOW: 260°C FOR 10 SEC  
 MANUAL SOLDER: 350°C FOR 3-5 SEC

NOTES:

1. PRODUCTS WITH 6 CONTACTS ARE PACKED IN BOX.

MATES WITH: - BB02-AZ

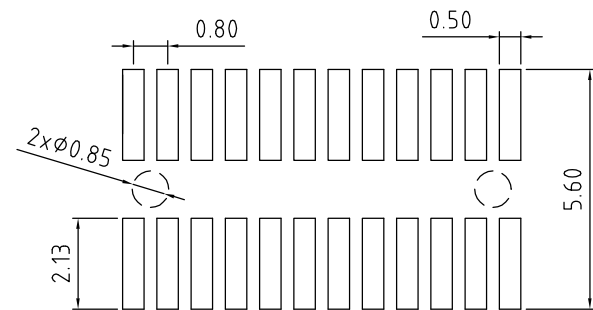
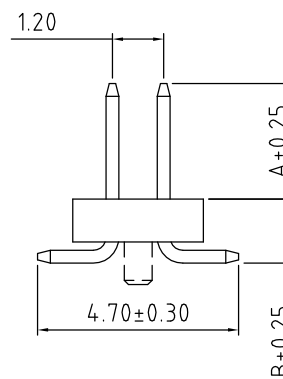
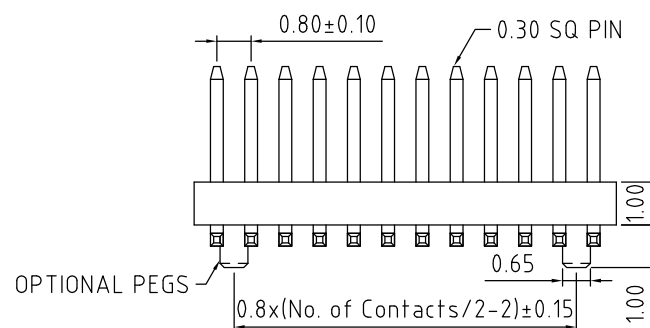
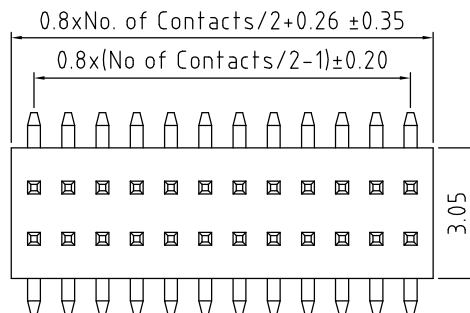

RECOMMENDED PCB HOLE LAYOUT

HOW TO ORDER

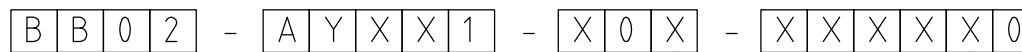

NO. OF CONTACTS:  
 06 to 98  
 00 = 100

CONTACT PLATING OPTIONS:  
 K = GOLD FLASH (STANDARD)  
 T = BRIGHT TIN  
 M = MATT TIN  
 D = GOLD FLASH ON CONTACT/BRIGHT TIN ON TAIL

PACKAGING OPTIONS:  
 3 = TUBE (SEE NOTE 1)  
 8 = T & R + CAP

PIN LENGTH A (1/10mm)  
 PLEASE SPECIFY PIN LENGTH  
 REQUIRED  
 I.E. 2.5mm = 25  
 STANDARD = 27

PIN LENGTH B (1/10mm)  
 PLEASE SPECIFY PIN LENGTH  
 REQUIRED  
 I.E. 2.5mm = 25  
 STANDARD = 15

LOCATING PEG OPTIONS:  
 A = WITH PEG  
 B = WITHOUT PEG

REV.	DATE & DRN
10	08/08/08-NYW - RELEASE
11	20/07/10-NYW - ADD PACKAGING OPTION 8
12	24/07/13 - NYW - CHANGE INSULATOR MATERIAL TO LCP
13	06/09/13 - NYW - ADD NOTE 1 TO PACKAGING REMOVE PACKAGING OPTION 6.

Scale: 8:1	THIRD ANGLE	Unstated Tolerances: X ± 0.25 .XX ± 0.15 .XXX ± 0.10	Material SEE NOTE
Drawn: NYW			NOT TO SCALE
App'd: XXX	Title: PIN HEADER		Unit: mm
Date: 6 SEP. '13	Revision: 1.3		



THIS DRAWING IS CONFIDENTIAL AND MUST NOT BE COPIED OR DISCLOSED WITHOUT WRITTEN CONSENT

Type BB02-AY
BB02-AY
Drawing Number:
Sheet 1 of 1
Drawing © E and O E